

38 Cove Gardens, Cove, Aberdeen, AB12

£168,000



Full Description

Well-presented and spacious, two/ three bedroom, semi-detached house is situated in a very popular location of cove in Aberdeen City. Spanning over two floors with a fully enclosed rear garden, this would be a great purchase for professionals or families. The accommodation comprises of: entrance porch with cupboard, leads to a spacious lounge with an under stair cupboard, good sized dining room which could be used as a bedroom if

Features

- Fully Enclosed Rear Garden
- Driveway Parking For 1-2 Cars
- Electric Heating
- Local Schools & Amenities Close By
- Regular Bus Links

required; fitted kitchen; two double bedrooms both with built-in wardrobes; a family bathroom with a three piece white suite and shower over bath; loft. Externally a fully enclosed rear garden with garden shed, driveway for 1-2 cars and ample on street parking is available on this incredibly quiet street. The property enjoys benefits of electric heating and double glazing. All floor coverings, light and window fittings will remain as part of the sale of the property. Viewing for this property is highly recommended to appreciate the property on offer. Situated in a quiet residential area of cove, located to the South of Aberdeen City has an array of local amenities close by such as shops, supermarkets, parks, pubs and so much more within easy walking distance. Regular transport links gives access to the rest of the city. Nurseries, Primary and Secondary schooling all nearby.

Contact Us

Thistles Estate Agents

T: 0330 1333 403

E: info@thistlesestateagents.co.uk







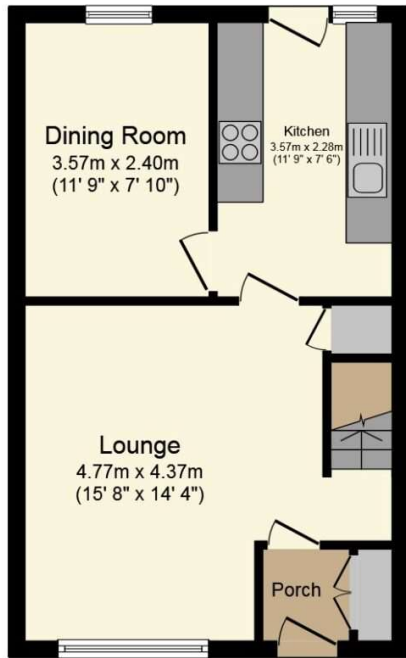

Ground Floor

Floor area 38.4 sq.m. (414 sq.ft.) approx

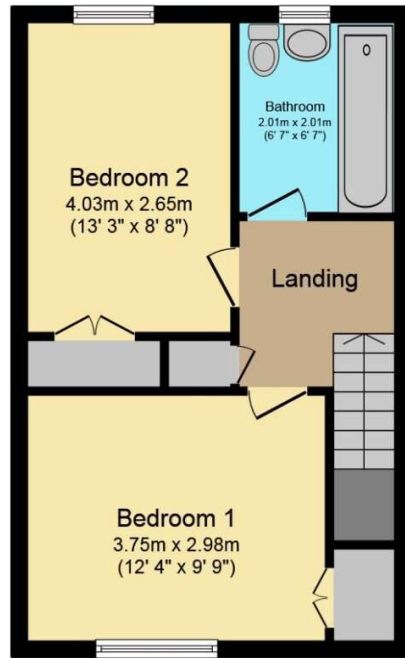

First Floor

Floor area 38.4 sq.m. (414 sq.ft.) approx

Total floor area 76.9 sq.m. (827 sq.ft.) approx

This Floor Plan is for illustration purposes only and may not be representative of the property. The position and size of doors, windows and other features are approximate. Unauthorized reproduction prohibited. © PropertyBOX