

Thistles

www.thistlestateagents.co.uk

info@thistlestateagents.co.uk

01224 600131

26 Broomhill Road (TFR), Aberdeen, AB10

£64,000



Full Description

Well presented, one-bedroom, top floor flat is available for sale in the Holburn Area of Aberdeen City. This recently decorated accommodation is ready to move into and comprises of: entrance hallway with storage cupboard & loft hatch; bright and airy lounge with natural light streaming through the large front facing window; fitted kitchen has a range of wall and base units, integrated electric hob, oven & fan, freestanding washing machine, fridge/ freezer; double bedroom with plenty of space for desks; Bathroom with a three piece white suite and shower over bath. Externally the property has ample unrestricted on street parking and a well-maintained communal garden with exclusive outhouse. Viewing for this property is highly recommended to appreciate the property on offer. Broomhill Road has an

Features

- Top Floor Apartment
- Unrestricted On Street Parking
- Shared Garden With Exclusive Outhouse
- Recently Decorated & New Carpets
- Double Glazing
- Security Entry System
- New Boiler
- Gigafast Internet Installed

array of local amenities close by such as bars, restaurants, shops, cafes, gym's, other entertainment options and so much more with-in easy walking distance. Also in easy walking distance is Robert Gordons University and Garthdee retail park. Regular transport links giving access to Aberdeen University and the rest of the city.

Contact Us

Thistles Estate Agents

23 Rubislaw Den North, Aberdeen
AB15 4AL

T: 01224 600131

E: info@thistlesestateagents.co.uk



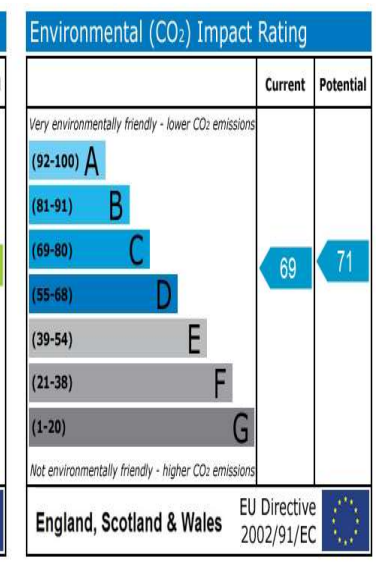
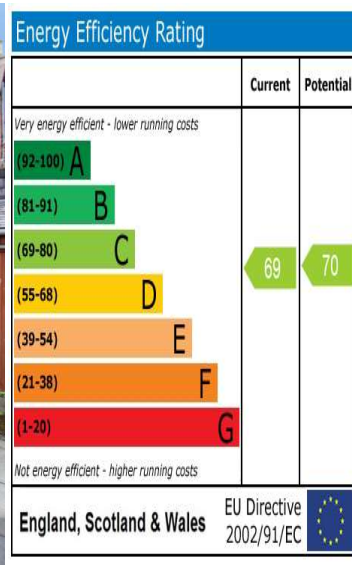

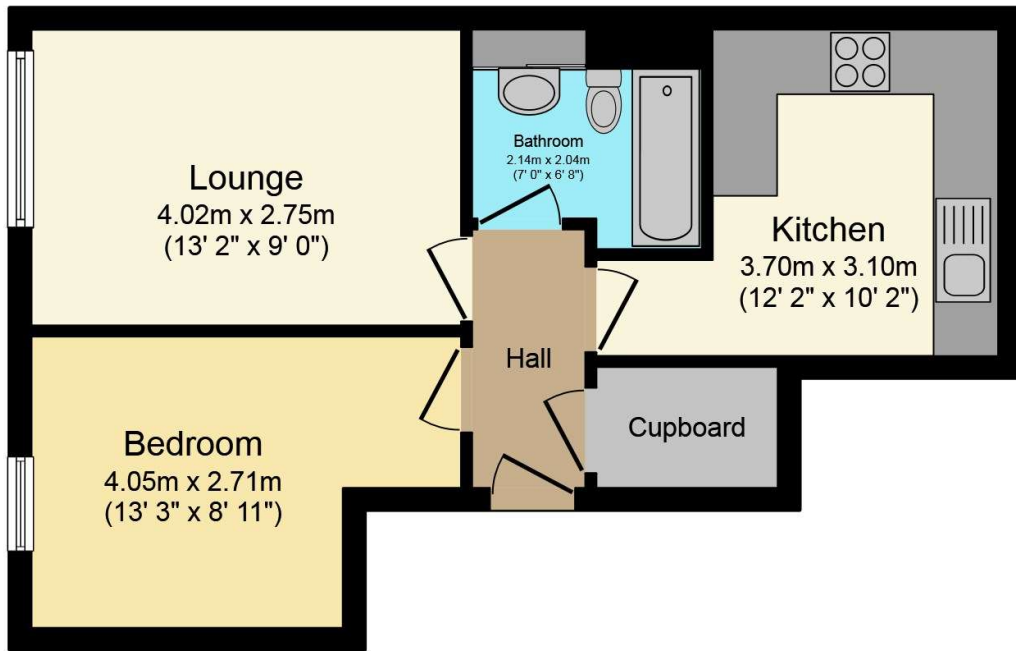

Floor Plan

Floor area 39.6 sq.m. (426 sq.ft.) approx

Total floor area 39.6 sq.m. (426 sq.ft.) approx

This Floor Plan is for illustration purposes only and may not be representative of the property. The position and size of doors, windows and other features are approximate. Unauthorized reproduction prohibited. © PropertyBOX