

Thistles

www.thistlestateagents.co.uk

info@thistlestateagents.co.uk

01224 600131

26f St Clair Street, Aberdeen, AB24 5AJ

£55,000



Full Description

Well presented, top floor, studio flat is available for sale in the King Street area of Aberdeen City. The accommodation is ready to move into and comprises of: an entrance hallway; good-sized lounge/kitchen, newly fitted modern kitchen with an integrated electric ceramic hob, oven and fan; Large double bedroom with two storage cupboards; Contemporary bathroom with a 3 piece white suite and shower over bath. Externally permitted parking is available. The property enjoys benefits of electric heating, double glazing and security entry. St Clair Street is located with in easy walking distance to Aberdeen University, Aberdeen Royal Infirmary (ARI) and City centre. Easy access to other areas of the city on King street with local and regular bus

Features

- Top Floor Studio Flat
- Ready To Move In To
- Central Location
- Regular Bus Links
- Morrisons Supermarket Close By
- Aberdeen University Close By
- Aberdeen Beach With In Easy Walking Distance
- Newly Fitted Modern Bathroom & Kitchen

links. The area has an array of local amenities include local shops, bars, restaurants, Aberdeen's sports village and many more.

Contact Us

Thistles Estate Agents

23 Rubislaw Den North, Aberdeen
AB15 4AL

T: 01224 600131

E: info@thistlesestateagents.co.uk





Energy Efficiency Rating		
	Current	Potential
<i>Very energy efficient - lower running costs</i>		
(92-100) A		
(81-91) B		
(69-80) C		76
(55-68) D		
(39-54) E		
(21-38) F	37	
(1-20) G		
<i>Not energy efficient - higher running costs</i>		
England, Scotland & Wales	EU Directive 2002/91/EC	

Environmental (CO ₂) Impact Rating		
	Current	Potential
<i>Very environmentally friendly - lower CO₂ emissions</i>		
(92-100) A		
(81-91) B		
(69-80) C		
(55-68) D		59
(39-54) E		
(21-38) F	35	
(1-20) G		
<i>Not environmentally friendly - higher CO₂ emissions</i>		
England, Scotland & Wales	EU Directive 2002/91/EC	



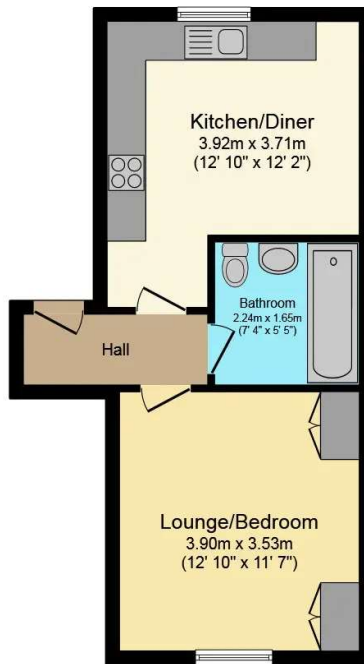

Floor Plan

Floor area 38.5 sq.m. (414 sq.ft.) approx

Total floor area 38.5 sq.m. (414 sq.ft.) approx

This Floor Plan is for illustration purposes only and may not be representative of the property. The position and size of doors, windows and other features are approximate. Unauthorized reproduction prohibited. © PropertyBOX